



LIGHT-OIL BURNERS AT TWO STAGES WITH JUMP OF PRESSURE [SERIE 2001]

MOD.: G1.22-G1.22R
G2.22-G2.22R

070045_2E 01

TECHNICAL DATA

MODEL		G1.22R	G1.22	G2.22R MAXI	G2.22 MAXI
Delivery	[kg/h]	1.4/2,0-5,0	1.4/2,0-5,0	2.2/4-9,8	2.2/4-9,8
Thermal power	[Mcal/h]	14.3/20,4-51	14.3/20,4-51	22.4/40.8-99,9	22.4/40.8-99,9
Thermal power	[kW]	16.6/23,7-59,2	16.6/23,7-59,2	26/47.3-116	26/47.3-116
Motor power	[W]	100	100	100	100
Pre-heater	[W]	30-110	-	30-110	-
Maximun absorbed power [W]		455	335	455	335
Fuel:		LIGHT-OIL 1.5°E a 20°C = 6.2 cSt = 35 sec Redwood N°1			
Pump pressure:		9-19 bar (STANDARD CALIBRATION) Max: 20 bar			
Electrical supply:		single phase 230V (-15% +10%) - 50Hz			
Level of electrical protection		IP40			
Safety time of control box:		=< 10 sec.			

OPERATING RANGE : Thermal power - Pressure in combustion chamber

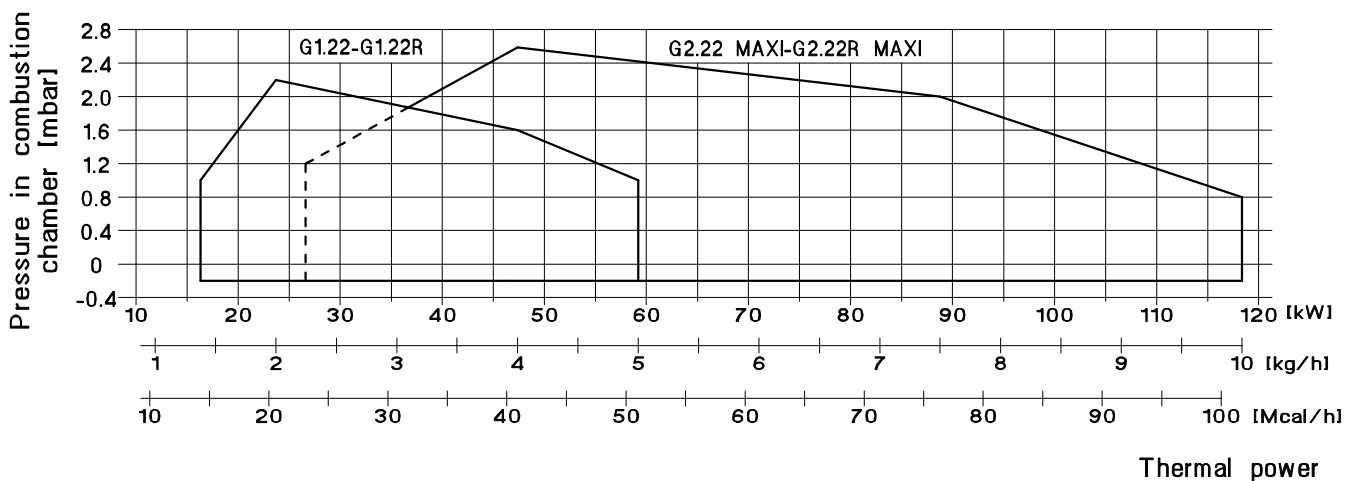

OVERALL DIMENSIONS [mm.]

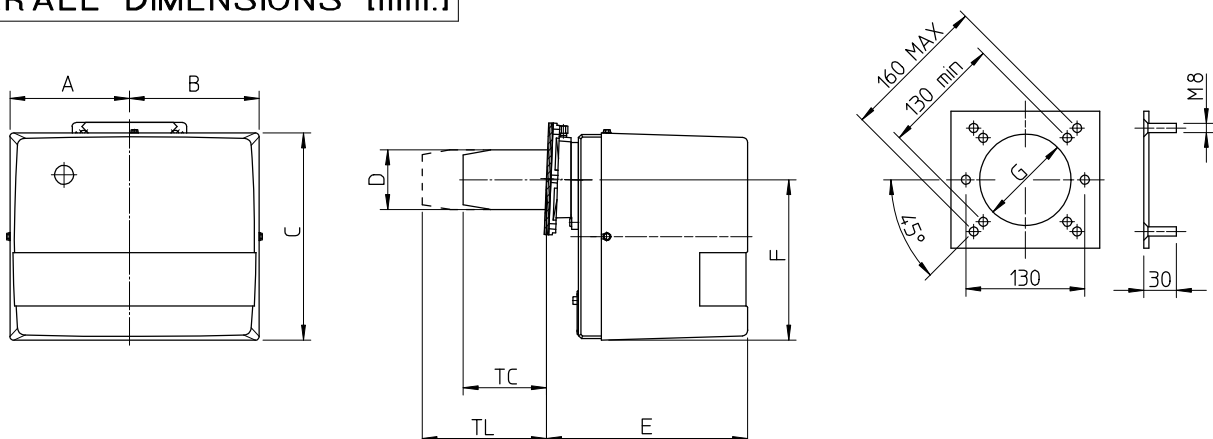

MODEL	A	B	C	D	E	F	G	TC	TL
G1.22-G1R.22	157	170	275	80	265	210	90	112	152
G2.22-G2R.22	157	170	275	80	265	210	100	112	152

143400, Московская область, г. Красногорск, ул. Успенская д.3, офис 304
Тел/факс.: +7 (495) 9806177, www.energogaz.su, energogaz@energogaz.su



**LIGHT-OIL BURNERS AT TWO STAGES
WITH JUMP OF PRESSURE
[SERIE 2001]**

MOD.: G X3.22
G X4.22

070045_2B | 01.01

TECHNICAL DATA

MODEL		G X3.22	G X4.22
Delivery	[kg/h]	4.8/7-15	6.8/10-20
Thermal power	[Mcal/h]	49/71-153	69/102-204
Thermal power	[kW]	57/83-178	80/118-236
Motor power	[W]	150	200
Pre-heater	[W]	-	-
Maximun absorbed power [W]		355	405
Fuel:		LIGHT-OIL 1.5°E a 20°C = 6.2 cSt = 35 sec Redwood N°1	
Pump pressure:		9-19 bar (STANDARD CALIBRATION) Max: 20 bar	
Electrical supply:		single phase 230V (-15% +10%) - 50Hz	
Level of electrical protection		IP40	
Safety time of control box:		=< 10 sec.	

OPERATING RANGE : Thermal power - Pressure in combustion chamber



OVERALL DIMENSIONS [mm.]

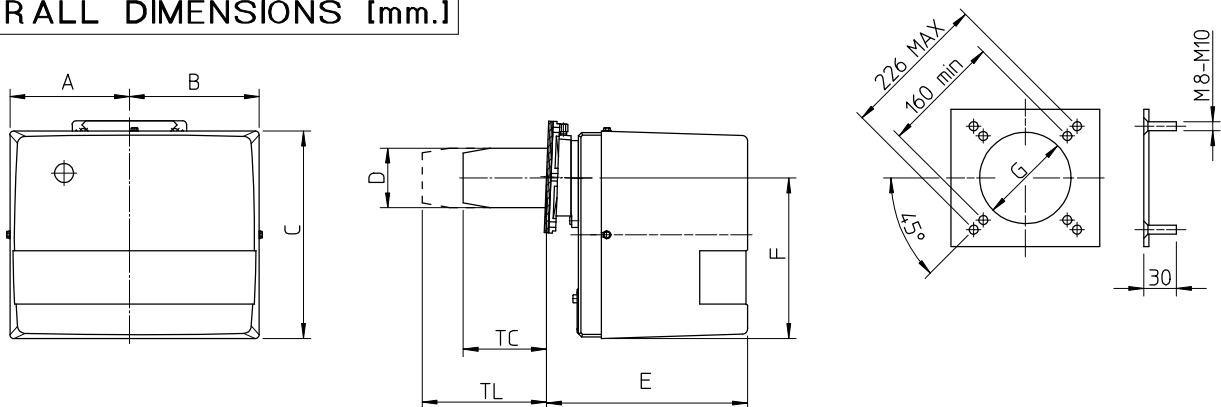

MODEL	A	B	C	D	E	F	G	TC	TL
G X3.22	179	169	318	110	298	248	120	130	250
G X4.22	179	189	318	125	298	248	140	130	250



**LIGHT-OIL BURNERS AT TWO STAGES
WITH JUMP OF PRESSURE
[SERIE 2001]**

MOD.: G1.22-G2.22
GX3.22-GX4.22

070045_2B

02

CORRECT POSITION OF THE ELECTRODES

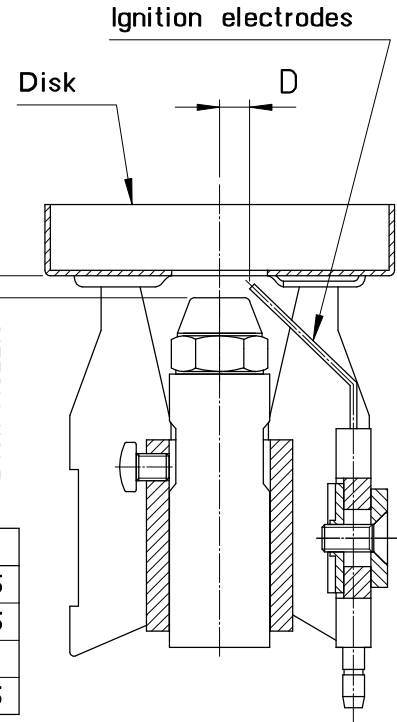
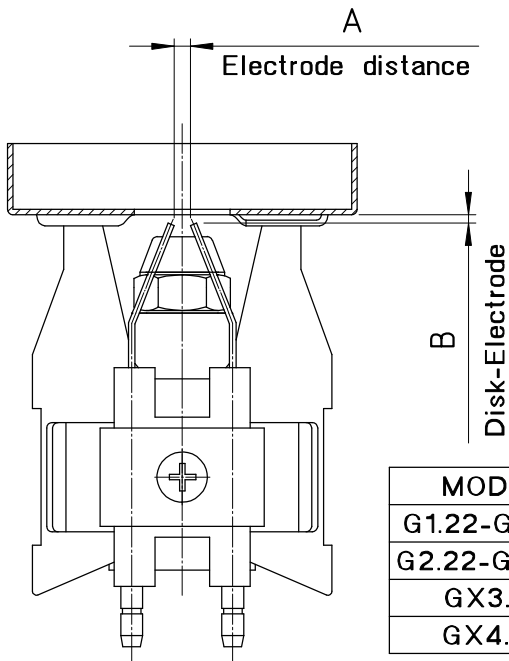

MODEL	A	B	C	D
G1.22-G1.22R	3	1.5	4	5.5
G2.22-G2.22R	3	1.5	4	5.5
GX3.22	3	3	5	6
GX4.22	3	3	6	7.5

PUMP PRIMING

Connect correctly the suction and the return pipes (see the arrows on the pump), make sure that no closed gates exist on the return, then ignite the burner by keeping lighted the photoresistance and by bleeding from the pressure switch connection up until the light-oil comes out.

HYDRAULIC SYSTEM SCHEME AND PIPE DIAMETERS

- 1 : Bottom filter
- 2 : Tank
- 3 : Return
- 4 : Suction
- 5 : Line filter
- 6 : Valve
- 7 : Pump

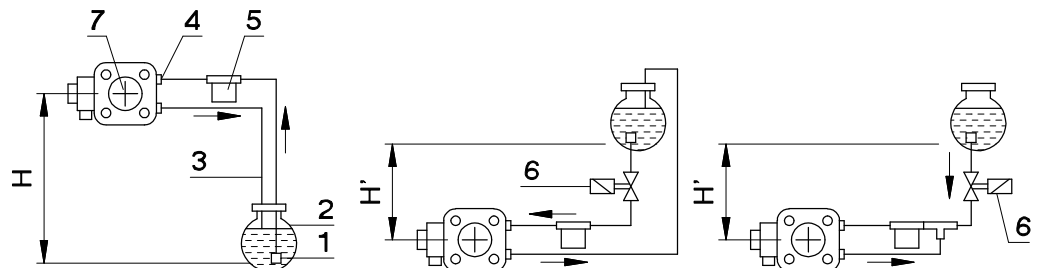

THE INSTALLATION MUST BE IN CONFORMITY WITH LOCAL LEGISLATION.

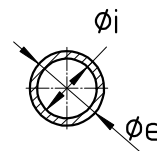
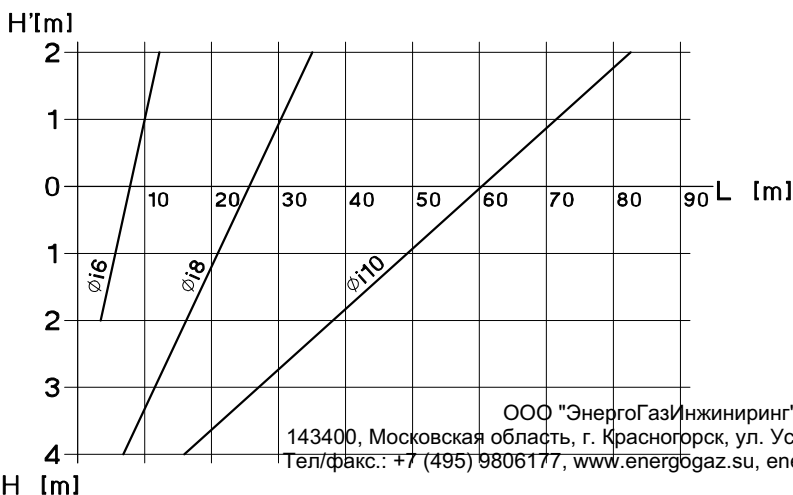

Details are referred to installatio without strugglings and perfectly sealing.

Copper pipes are recommended.

Negative pressure must not be

higher than max. 0.4 bar.

ООО "ЭнергоГазИнжиниринг"
143400, Московская область, г. Красногорск, ул. Успенская д.3, офис 304
Тел/факс.: +7 (495) 9806177, www.energogaz.su, energogaz@energogaz.su

H [m]



**LIGHT-OIL BURNERS AT TWO STAGES
WITH JUMP OF PRESSURE
[SERIE 2001]**

MOD.: G1.22-G1.22R
G2.22-G2.22R

070045_2B

03

TABLE OF INDICATIVE CALIBRATIONS

Calibrations effected with pressure in chamber 0,01 mbar. The definitive calibration must be done in operation by means of a combustion analyser.

MODEL	NOZZLE G.P.H. x a°	HEAD [NOTCH N°]	1° STAGE				2° STAGE			
			PRESSURE [bar]	DELIVERY [Kg/h]	THERMAL POWER [KW-Mcal/h]	AIR [NOTCH N°]	PRESSURE [bar]	DELIVERY [Kg/h]	THERMAL POWER [KW-Mcal/h]	AIR [NOTCH N°]
G1.22	0.40x80°	8	9	1.4	16.6-14.3	0.5	19	2.0	23.7-20.4	3.5
	0.60x60°	13	9	2.1	24.8-21.4	3.5	19	3.0	35.5-30.6	6
G1.22R	0.75x60°	16	9	2.6	30.8-26.5	5	20	4.0	47.3-40.8	8
	1.00x60°	20	9	3.5	41.4-35.7	5.5	19	5.1	60.3-52	9.5
G2.22	1.00x60°	0	9	3.5	41.4-35.7	5.5	20	5	59.2-51	9.5
	1.25x60°	4	9	4.2	49.7-42.8	6.5	19	6.1	72.2-62.2	10.5
G2.22R	1.35x60°	8	9	4.7	55.6-47.9	7.5	19	7	86.9-74.9	11
	1.65x60°	12	9	5.6	66.3-57.1	9	20	8	94.7-81.6	11.5
G2.22R	1.75x60°	16	9	6.1	72.2-62.2	9	20	8.8	104.1-89.8	13
	2.00x60°	20	9	6.9	81.6-70.4	9.5	19	10	118.3-102	14.5

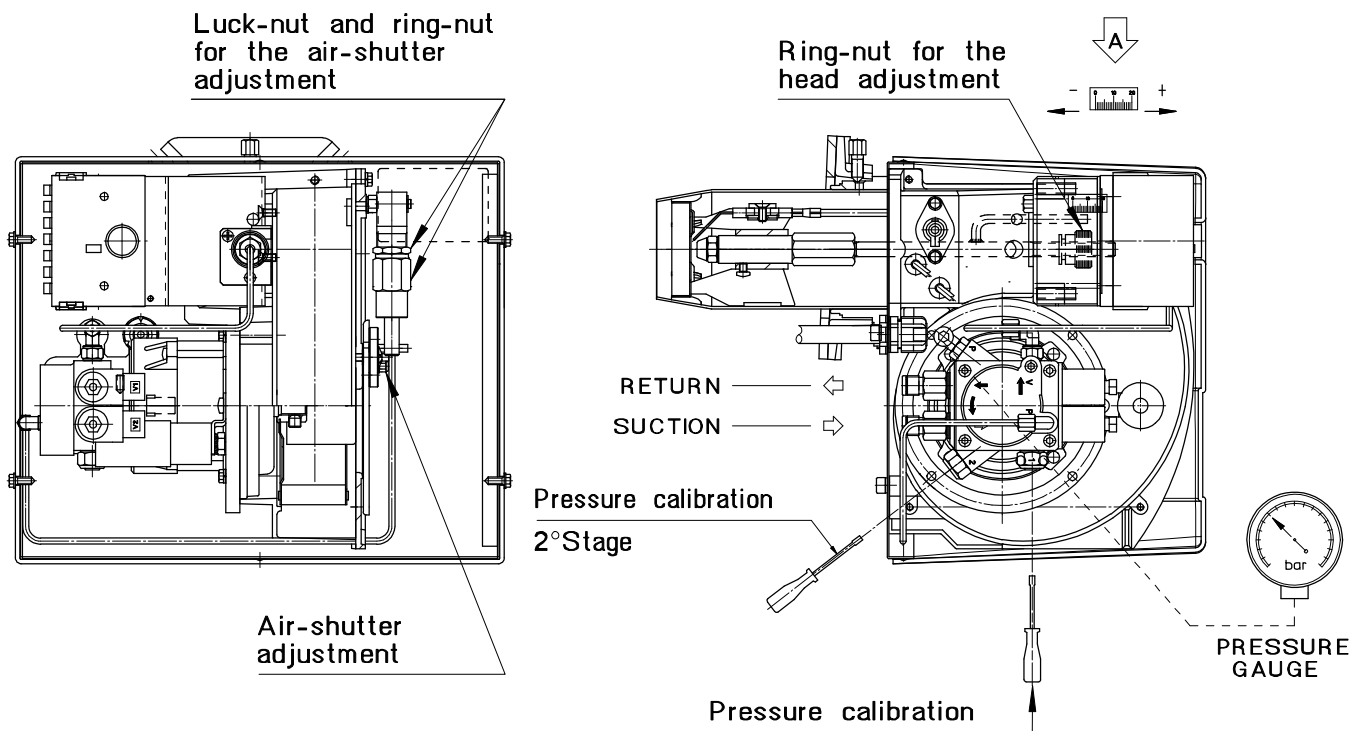

ООО "ЭнергоГазИнжиниринг"
143400, Московская область, г. Красногорск, ул. Успенская д.3, офис 304
Тел/факс.: +7 (495) 9806177, www.energogaz.su, energogaz@energogaz.su



**LIGHT-OIL BURNERS AT TWO STAGES
WITH JUMP OF PRESSURE
[SERIE 2001]**

MOD.: GX3.22
GX4.22
070045_2E 04

TABLE OF INDICATIVE CALIBRATIONS

Calibrations effected with pressure in chamber 0,01 mbar. The definitive calibration must be done in operation by means of a combustion analyser.

MODEL	NOZZLE G.P.H. x a°	HEAD [NOTCH N°]	1° STAGE				1° STAGE			
			PRESSURE [bar]	DELIVERY [Kg/h]	THERMAL POWER [KW-Mcal/h]	AIR △x°	PRESSURE [bar]	DELIVERY [Kg/h]	THERMAL POWER [KW-Mcal/h]	AIR △x°
GX3.22	1.35x60°	4	9	4.8	56.9-49	8°	19	7	83-71.4	12.5°
	1.50x60°	6	9	5.2	61.7-53	8°	20	8	94.9-81.6	12.5°
	1.75x60°	7	9	6.3	74.7-64.3	10°	19	9	106.7-91.8	17.5°
	2.00x60°	9	9	7.3	86.6-74.5	12.5°	18	10	118.6-102	17.5°
	2.00x60°	10	9	7.3	86.6-74.5	12.5°	20	11	130.5-112.2	20°
	2.25x60°	12	9	8.0	94.9-81.6	12.5°	20	12	142.4-122.4	22.5°
	2.50x60°	14	9	8.8	104.4-89.8	15°	20	13	154.2-132.6	22.5°
	2.75x60°	15	9	9.9	117.4-100	17.5°	19	14	166-142.8	30°
	3.00x60°	17	9	10.3	122.2-105	20°	20	15	177.9-153	35°
GX4.22	2.00x60°	2	9	7	82.8-71.4	10°	19	10	118.3-102	17.5°
	2.25x60°	3	9	8	94.6-81.6	12.5°	19	11	130.2-112.2	20°
	2.50x60°	4	9	9	106.5-91.8	15°	17	12	142-122.4	22.5°
	2.50x60°	6	9	9	106.5-91.8	15°	19	13	153.6-132.6	22.5°
	2.75x60°	8	9	10	118.3-102	17.5°	19	14	165.8-142.8	22.5°
	3.00x60°	10	9	10.5	124.2-107.1	17.5°	19	15	177.5-153	25°
	3.25x60°	12	9	11.5	136-117.3	17.5°	17	16	189.3-163.2	25°
	3.50x60°	14	9	12.5	147.9-127.5	20°	17	17	201.1-173.4	27.5°
	3.50x60°	16	9	12.5	147.9-127.5	20°	19	18	213-183.6	30°
	4.00x60°	18	9	14	164.7-142.8	22.5°	19	19	224.8-193.8	35°
	4.00x60°	20	9	14	164.7-142.8	22.5°	19	20	236.6-204	45°

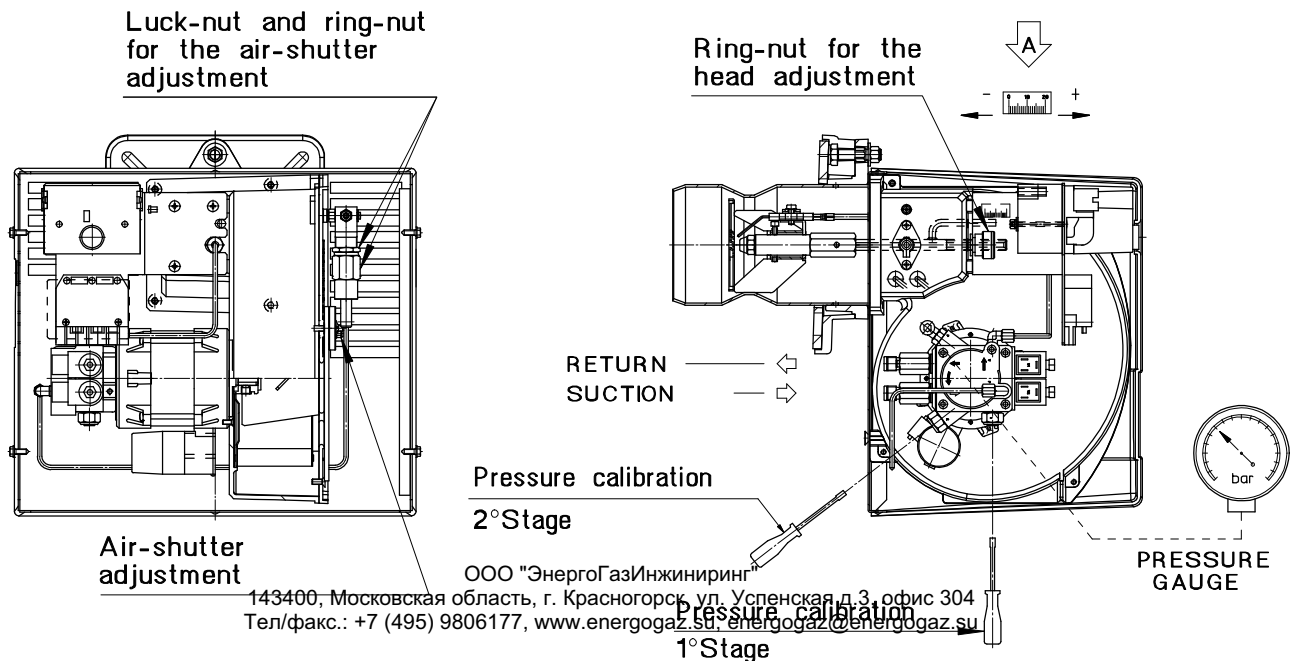

ООО "ЭнергоГазИнжиниринг"
143400, Московская область, г. Красногорск, ул. Успенская д.3, офис 304
Тел/факс.: +7 (495) 9806177, www.energogaz.su, energogaz@energogaz.su